



Motor yacht 38 m

General

Yard no.
Delivery date
Basic functions
Classification BV

Dimensions

Length o.a. 38.50 m
Beam o.a. 7.730 m
Depth at sides 3,900 m
Draught aft 2.200 m
Material Steel

Performances (trials)

Speed :14.0 knots

Engine

Main engines : 2 x Cummins K19-M4
Total power : 2x 720 HP/2100 rpm
Genset/Power/ :Generator PERKINS
Hours/Brand 2x 80 KW
Electric rigging :380/220/24 v

Deck/Safety rigging

Outboarder Yamaha 2x 40 HP 4 Stroke
Windlass 2000 watt DATA
Auto Extinguisher engine room
Life Jackets 16
Liferaft 2 x 8 person

Accommodation

Crew 6
Guest 10

Galley

Cooker electric
Oven/Microwave Bosch
Refrigerator Bosch
Deep Freezer Bosch
Ice Maker Yes
Washingmaschine Bosch
Water Maker Yes

Nautical and communication equipment

Radar : Furuno
GPs : Furuno
Echosounder : Furuno
Navtex : Furuno
VHF radio :2x Sailor
SSB radio telephone :Furuno

Plan View
Flying Bridge

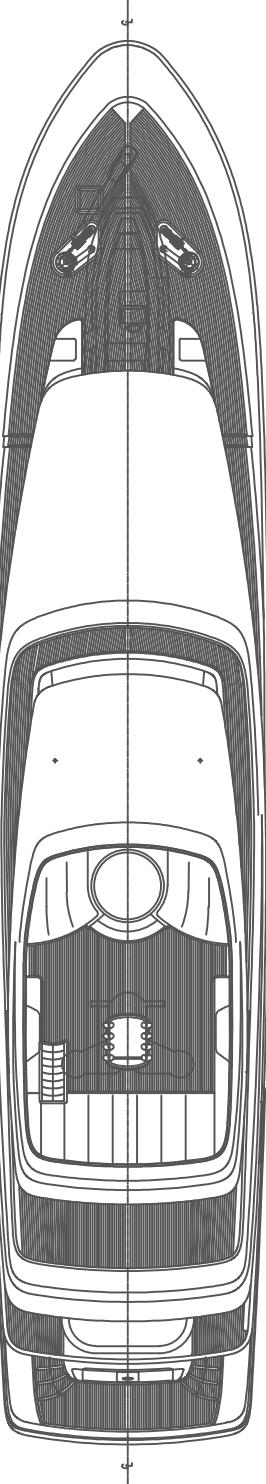

Plan View
Upper Deck

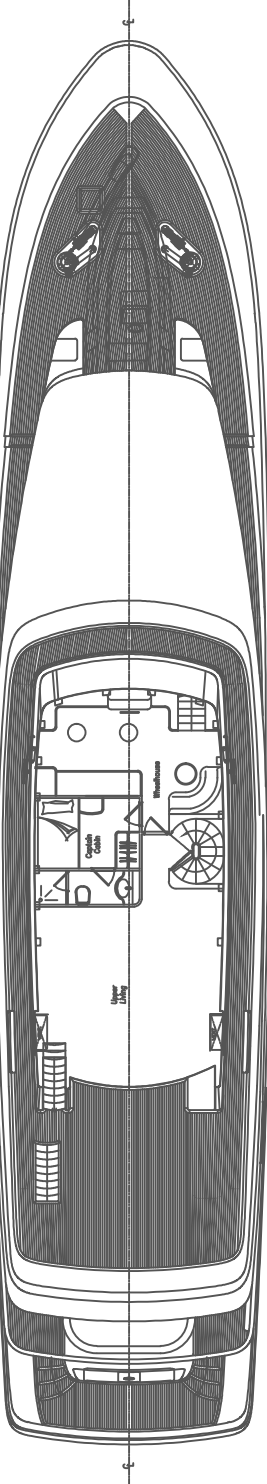

Plan View
Main Deck

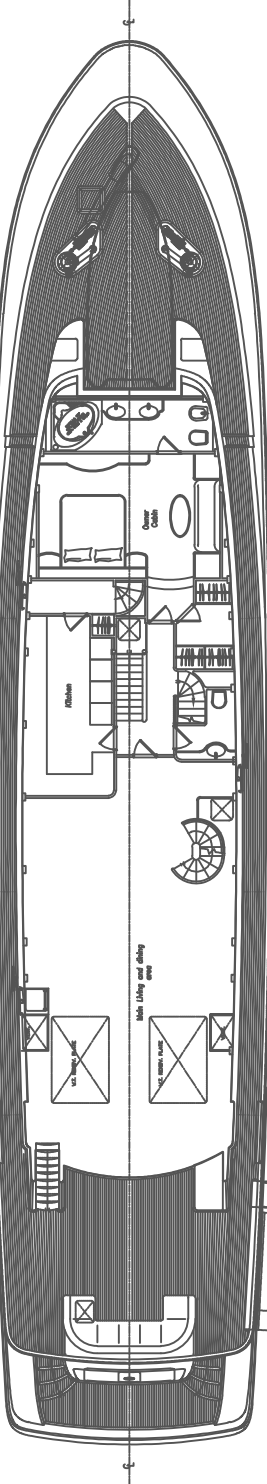

Plan View
Lower Deck

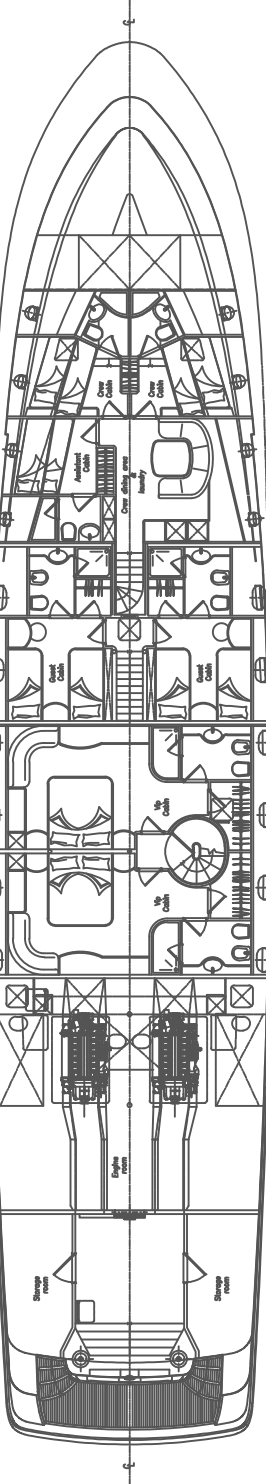

CLASSIFICATION

BUREAU VERITAS
 CHARTERED YACHT / B
 CLASSIFICATION REF. NO. 02363.L.L. - BURGARD REF. NO. 11.522

MATERIAL

STEEL GRADE 'A'

WELDINGS

ACCORDING TO RULES

MAIN DIMENSIONS

LENGTH OVER ALL	L.O.A. =	38.570 M
LENGTH BETWEEN PERPENDICULARS	L.B.P. =	31.395 M
LENGTH BETWEEN PERPENDICULARS AT DECK	L.B.P. DECK =	32.175 M
BEAM AT DECK	B. DECK =	3.810 M
BEAM AT WATERLINE	B. WL =	3.270 M
DEPTH	D. =	2.500 M
MAXIMUM DRAUGHT	T. =	0.500 M
FRAME SPACING	S. =	2.475 M
ENGINE 2 MTU 12V 2000 A7D		



2017-2018

GENERAL ARRANGEMENT

NO.	REV.	DATE	DESCRIPTION
1	01	2017-02-20	ISSUE FOR CONSTRUCTION

2017-2018
 2100 St. Nicholas
 New York, NY 10014
 Tel: 212 269 6710